

# C-426 AC HUSKEY II

*Manoeuvrable & ergonomic tow tractor*



Photos are shown with optional features.



The C-426 AC Huskey II combines high-powered towing in a compact manoeuvrable tow tractor, while providing optimal safety, comfort and ease of use.

With its 17 hp AC motor coupled with Taylor-Dunn's own GT drive, the Huskey provides an impressive 13,610 kg gross tow load.

The C-426 AC Huskey II is equipped with a cushioned grip steering wheel, hitch with hand release, suspension seating and high visibility position. The operator enjoys effortless control in tight and narrow spaces with the high ratio steering gear and the 189 cm turning radius.

Optional features include cab or overhead guard, left-side battery extract and strobe light.

## Features

- Ergonomic design for operator comfort
- Maximum visibility for safety
- Fully welded all-steel construction
- Large battery compartment
- Customisable to fit your application



# C-426 AC HUSKEY II TOW TRACTOR

## Performance

TOW CAPACITY	13,610 kg*
DRAWBAR PULL	normal ultimate
	2.7 kN 13.3 kN
MAX SPEED (UNLOADED)	16 km / h
TURNING RADIUS	189 cm

\*Based on Standard Configuration: Actual towing capacity is dependent on application, vehicle configuration, ballast weight, and operating environment.

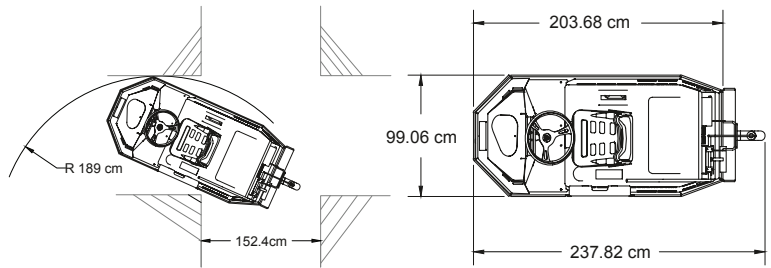

## Dimensions

OVERALL LENGTH	237 cm
OVERALL WIDTH	99 cm
OVERALL HEIGHT (without cab)	137 cm
OVERALL HEIGHT (with cab)	209.5 cm
WHEEL BASE	109 cm
STEP HEIGHT	48 cm

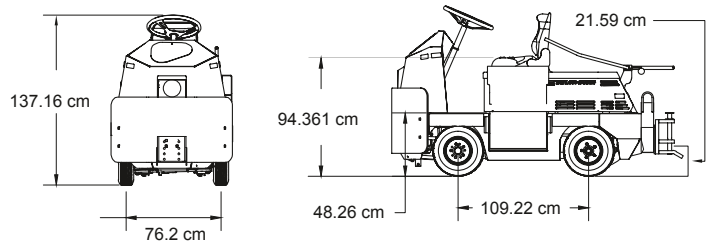

## Power supply / Drive train

MOTOR	17 hp AC, enclosed
SYSTEM VOLTAGE	48 volt
DRIVE AXLE	GT automotive differential
BATTERY	Less industrial battery, compartment 32" L x 18-1/2" W x 24" H
CHARGER	Less charger
CONTROLLER	Self diagnostic AC speed controller with integrated thermal protection and safety monitoring features

## Chassis

FRAME	Fully welded, unitised, 10 gauge steel body, 3/16" steel chassis, 1/2" thick steel full
STEERING	Manual, re-circulating ball
SUSPENSION	Front and rear coil springs, rear shock absorbers
BRAKES	4-wheel hydraulic disc, automatic / electric parking brake
TYRES	4.00 x 8, soft solid, traction tread

## General

MAXIMUM OCCUPANCY	113kg
UNIT WEIGHT	1125 kg
SEAT	Single, adjustable, Black vinyl, with spring suspension and electric interlock switch
INSTRUMENTATION	Smart View Display (battery status indicator, hour meter, fault code display) forward / reverse selector, key switch, electric horn, reverse alarm, DC / DC converter, power cut-off switch
LIGHT ACCESSORIES	Head light, taillight, brake light
HITCH	Spring loaded E-type with hand release lever
CONFORMANCE	Type E OSHA 1910.178, ANSI B56.9

## Options

- Portable / built-in charger
- Reverse lights
- Non-marking tyres
- Hitches
- Left-side battery extract
- Beacon or strobe light
- Directional signals
- Extra wide traction tyres
- Soft solid tyres
- Various hitches
- Custom paint colour
- Galvanising / undercoating

 **Toyota Material Handling Australia** 8 Secombe Place, Moorebank NSW 2170

 **1800 425 438**

 [www.toyotamaterialhandling.com.au](http://www.toyotamaterialhandling.com.au)

