

BIGFOOT XL

Comfort & performance utility vehicle



Photos are shown with optional features.



Taylor-Dunn is proud to announce an addition to its line of ergonomic BIGFOOT electric vehicles. The new BIGFOOT XL is a utility vehicle with a larger operator's compartment, hill climbing gusto, speed up to 29 km/h, and all-wheel hydraulic disc brakes.

Equipped with a 17 hp, 48 volt AC motor, GT drive, and rack and pinion steering, this electric utility vehicle will out-perform any other in its class.

Available customisations include deluxe cab, econo cab, fold-away seat, steel panel box, lockable cargo box, stake sides and aluminium drop-down sides.

Features

- 48 volt AC system
- 29 km/h speed, 54 km range
- 1361 kg load capacity
- Zero Emissions
- Exceptional Handling
- XL Operator's Compartment
- Tilted Steering
- Adjustable Seats



BIGFOOT XL UTILITY VEHICLE



Performance

LOAD CAPACITY	1361 kg*
MAX SPEED (UNLOADED)	29 km / h
TURNING RADIUS	368 cm
TOW CAPACITY	4536 kg

*Based on Standard Configuration: Actual towing capacity is dependent on application, vehicle configuration.

Dimensions

OVERALL LENGTH	332 cm
OVERALL WIDTH	145 cm
HEIGHT (with cab)	132 cm (188 cm)
WHEEL BASE	158 cm
GROUND CLEARANCE	14.7 cm
BED SIZE	137 x 196 cm

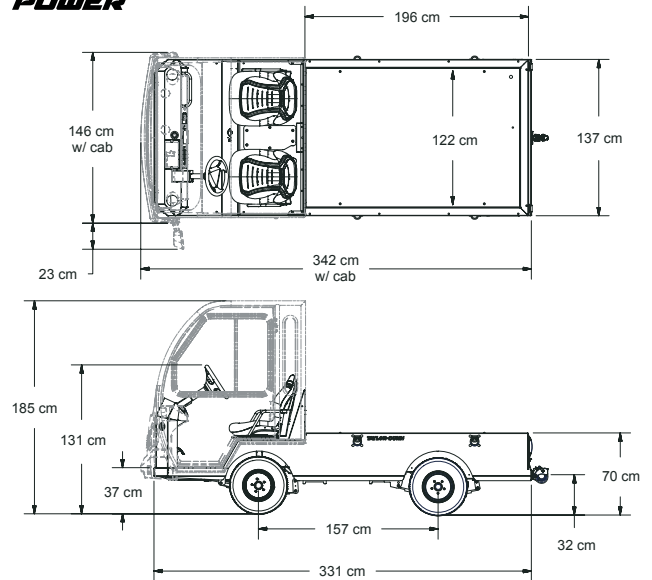

Power supply / Drive train

SYSTEM VOLTAGE	48 volt
MOTOR	17 hp, 13 kW AC
DRIVE AXLE	Helical gear, oil bath transaxle, GT automotive differential
BATTERIES	260 amp-hour, lead acid, 6 volt, 8 each
CHARGER	Built-in, 115 VAC / 60 Hz, 1kW with interlock, 48V: 17 amp SCR
CONTROLLER	Solid state self diagnostic AC speed controller



GT Automotive Drive

Chassis

FRAME	Fully welded, unitised, 12 gauge, smooth skin steel body
STEERING	Rack and pinion
SUSPENSION	Multi-leaf springs, front and rear
BRAKES	Front and rear hydraulic disc brakes, electric parking brake
BUMPERS	Heavy duty steel integrated front & rear
TYRES	20.5 x 8 x 10, load range E, pneumatic

Options

- Fold-away seats
- Stake sides
- Econo cab
- Portable charger
- Strobe light
- Vinyl doors
- Aluminum drop-down sides
- Deluxe cab w/ steel doors
- Diamond plate deck
- Lockable cargo box
- Lift out battery box
- Directional signals
- Steel panel box
- Battery watering system
- Various hitches
- Undercoating
- Galvanised frame
- Optional paint colours

General

UNIT WEIGHT	891 kg
SEATS	Black adjustable bucket seats, driver's seat electrical interlock, 2 person
INSTRUMENTATION	Clear view display (speed, distance, battery status indicator, hours, input diagnostic & fault code display), dual USB port, emergency power cut-off switch, light switch, forward / off / reverse selector, reverse alarm, high / low speed selector, key switch, DC / DC converter (on with key switch), and electric horn
LIGHT ACCESSORIES	Dual LED head lights, taillights and brake lights
CONFORMANCE	Type E OSHA 1910.178, ANSI B56.8



Toyota Material Handling Australia 8 Secombe Place, Moorebank NSW 2170
1800 425 438
www.toyotamaterialhandling.com.au

